

SOUTH ISLAY DEVELOPMENT

SOUTH ISLAY NEWS

October 2021

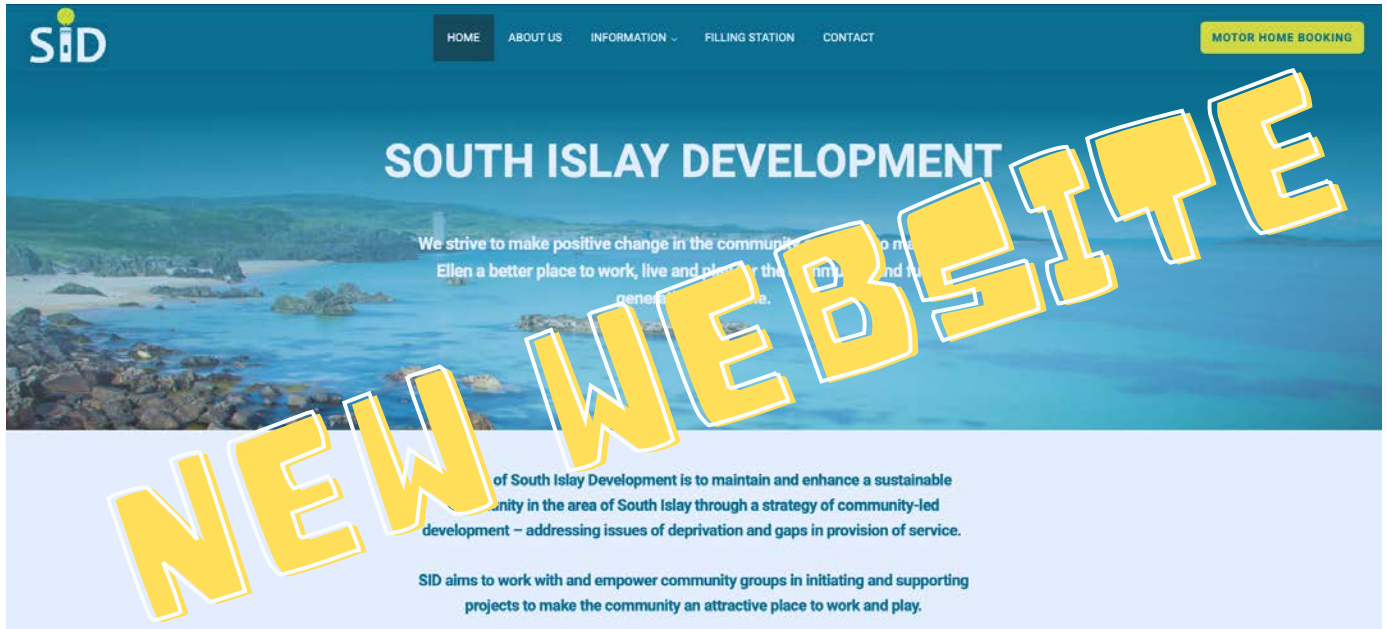

There has been a lot happening behind the scenes at South Islay Development this month!

The SID website is now LIVE. SID have been working behind the scenes in partnership with Ben Shakespeare Photography to bring together a website to showcase the hard work of the South Islay community over the last ten years.

We hope the website will be a focal point for the community near and far to keep up to date on all things SID. The website will provide a landing page for you to find the latest news on South Islay's projects, documents to download and much, much more.

The website will host a new bookable page for your community owned Filling Station Motorhome Services, making the process of booking a pitch more flexible and accessible for our visitors.

Check it out at: www.southislay.co.uk

The SID Office is now OPEN in the Ramsay Hall.

Monday to Thursday 9am – 4.30pm
Friday 9am – 2pm
(No Lunch Closures)

These hours may be subject to change.
The staff are continuing to work a mixture
of home and office based working pattern.

If the office is closed when you visit, please contact by telephone or email.

Contact us:

Call SID Office: 01496 300 579

Email Alyson: southislaydevelopment@gmail.com

Email Rosie: portellenplayingfields@gmail.com

Email Rose: southislayassisatnt@gmail.com

We require everyone to wear a face
covering within the office buildings
and adhere to UK government guidelines.

Port Ellen Playing Fields - The New Pavilion

Project Timeline



- Building Warrant is being prepared now Sept/Oct 2021



- Out to tender for construction works: January 2022



- Contractor appointed for construction works: April 2022



- Onsite start: May/June 2022

Following the extensive community consultation an application was submitted for planning permission in August 2021.

In the meantime, SID continues to work alongside their design team, to finalise the overall building design.

Work is also ongoing to secure the necessary funding required to fully finance the project.

The design team are currently preparing the building warrant. SID hopes that construction work will begin onsite in May/June 2022.



PORT ELLEN PLAYING FIELDS NEW PAVILION PROJECT COST

A Quick Breakdown

- Funding Awaiting Results
- Scottish Government - Regeneration Capital Grant Fund Glenmorangie & NHI - The Kildalton Project



The Scottish Government
Riaghaltas na h-Alba

The
GLENMORANGIE
COMPANY

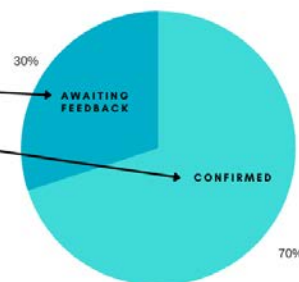

What is the Sonas Childcare Project?

Sonas Childcare is a registered SCIO set up by a group of volunteer parents who recognised the need in the community for a day care facility for children under three years of age.

Earlier this year, SID and Sonas Childcare were very pleased to have been successful in being awarded Crown's Estate funding from Foundation Scotland to develop the initial early development stages of this project.

We are very pleased to be working with Argyll & Bute Council, Live Argyll and AMP Architects to work on a feasibility study of The Ramsay Hall. Considering if this important building in the community could accommodate a childcare facility at the rear as well as keeping the strong community hall at the front.

Sonas Childcare and SID are looking forward to working with the community over the next few months to develop a sustainable option to take forward. Keep an eye out for community consultation events coming soon.

EXTERNAL STORAGE STORES

These rooms will be used by The Port Ellen Bowling Club and Footballers.

KITCHEN & BAKERY AREA

This area will be tendered nearer to completion for interested parties/individuals to apply to lease this business opportunity.

The New Pavilion

Let's look inside!

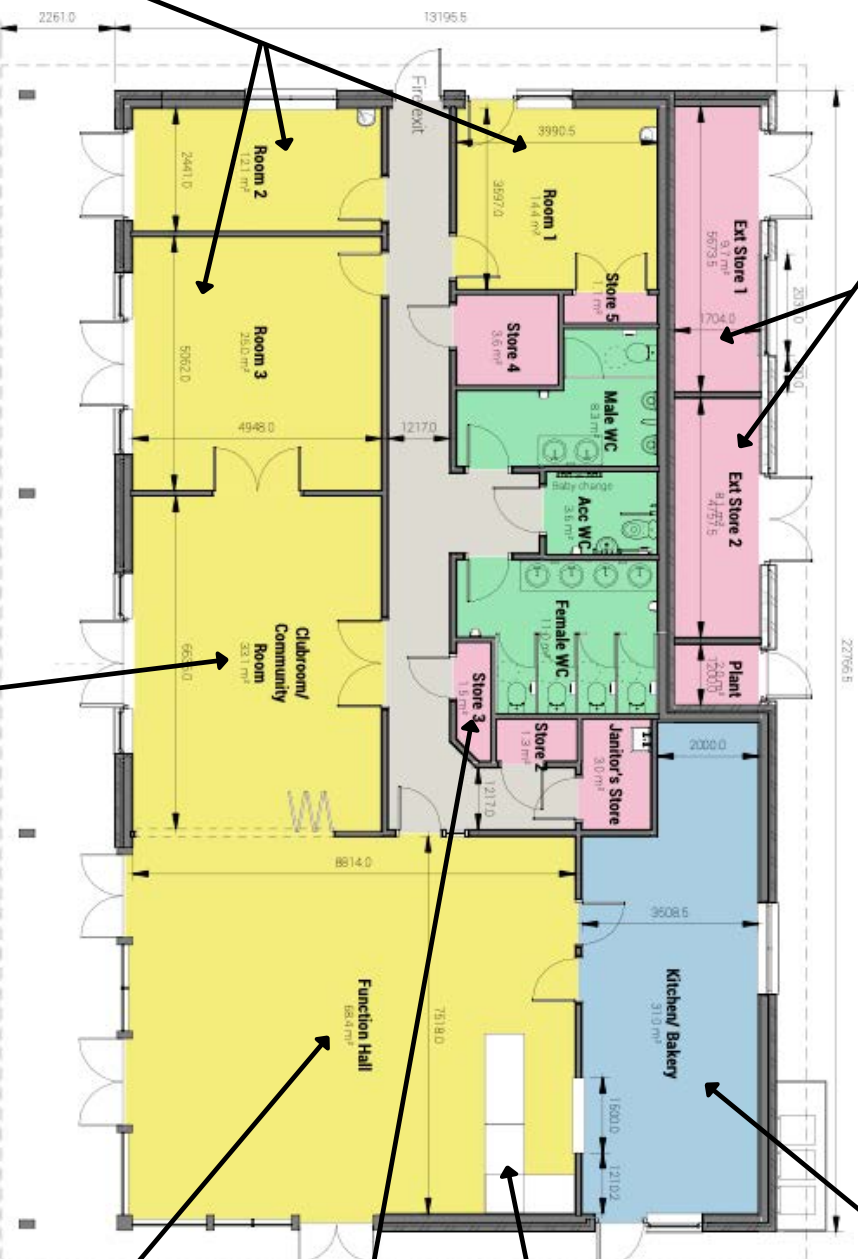

ROOMS 1 TO 3

These rooms will be available for charities, businesses and individuals to rent either short or long term.

CLUBROOM

This room is available for the whole community to hire for various functions.

FUNCTION HALL

This large area can be used daily by the cafe to host its customers. It will be available for the community to use or hire.

STORE ROOMS

These will be available for regular users to store equipment, extra tables and chairs etc.

Legend FRONT HOUSE COUNTER

This will be a front of house counter for the cafe, where you can hire equipment, purchase confectionary

- Circulation
- Community
- Kitchen
- Storage
- Toilets

Port Ellen Filling Station

> FUELLING THE COMMUNITY <



As well as filling a very important need within the South of Islay for everyone, the profit generated from the Filling Station facilities are pumped directly back to the Community.

We would like to take the opportunity to say a massive 'Thank You' to the community near and far who have supported The Filling Station when the community decided to buy and managed this essential community service in 2014. Over the past 7 years, the small business has grown in strength, securing 3 part time jobs in the community along with introducing new services – the jet wash, air compressor and motorhome facilities.

SID are very pleased to announce that it has successfully secured funding to upgrade the Filling Station Fuel Pumps, we are currently working with Industrial Services to work out a plan of action for the works. Alongside the outside works, we are excited to say that the interior of the shop will be upgraded throughout the winter. We will keep you posted on all the developments.

Get to know your SID Directors:

John Findlay - SID/SITCo Director/Chair

Patrick McGrann - Director/Vice Chair

Alex Gillespie - Director

Diana Buller - Director

Dionne Johnston - Director

Gordon Currie - SID/SITCo Director

Grant Addison - Director

Ian Faggetter - SID/SITCo Director

Jackie Thomson - Director

James McFarlane - Director

Jim Porteous - Director

Jordon Paisley - Director

Niall Kirkpatrick - SITCo Director



Pop in and chat with the SID Staff:

Alyson MacGillivray - SID Development Manager

Rosie MacLellan - PEPF Project Manager

Rose Mota Dos Reis - Admin and Finance Officer

James McDonald - Digital Marketer

Lucy Sutherland - Sonas Childcare Project Manager

The Filling Station Staff:

Lizzie Fitzpatrick - Supervisor

Alan Kerr & Isla Swanson
- Fuel Attendants



ISLAY COVID-19 FUND

SMALL GRANTS FOR LOCAL GROUPS & ORGANISATIONS

Are you a charity or group on Islay/Jura looking to re-open safely, start new or progress with projects affected by Covid?

IF SO, YOU MAY BE ELIGIBLE FOR A GRANT UP TO £2K TOWARDS YOUR COVID-19 PROJECT

To request an application form or discuss in more detail please contact:
Alyson MacGillivray at the SID Office
T: 300 579 or E: southislaydevelopment@gmail.com